



SENDING STICKERS TO FURNACE

If you are sending stickers to Furnace for assembly with your project, you will need to ensure they are **printed and oriented properly** to avoid additional costs and turnaround time:

- All stickers need to be orientated on a 3" core as depicted in the diagram below
- The paper liner should be no more than 1/8" wider than the sticker stock
- Clear labels must be supplied with paper liners that contain black automation registration marks

Stickers that do not meet these specifications will need to be hand applied, which is more expensive and will add time to the turnaround of your project.

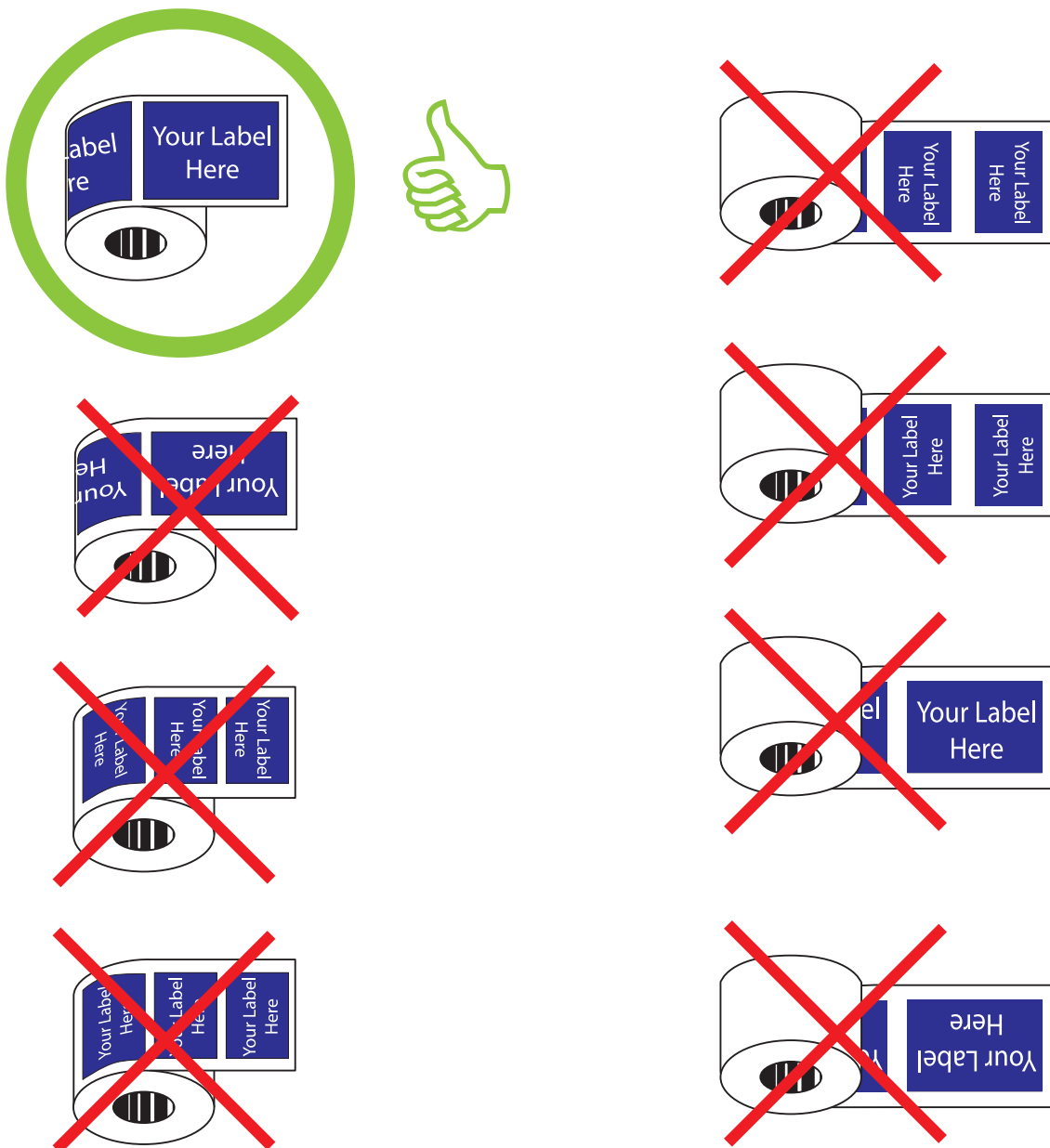

For more info email: sales@furnacemfg.com • 703-205-0007

Stay connected: furnacemfg.com • [@furnacemfg](https://twitter.com/furnacemfg)